

W110 and W130 Wheel Loader Service Manual 6-81160

Table of Contents

Description	Section No.	Form No.
General		
	Tab 1	
Section Index - General		6-81180
Standard Torque Specifications	1001	6-80470
Fluids and Lubricants	1002	6-81190
Metric Conversion Chart	1003	6-80690
Engines		
	Tab 2	
Section Index - Engines		6-81200
Engine and Radiator Removal and Installation	2000	6-81210
Stall Tests	2002	6-81220
For Engine Repair, See the Engine Service Manual		6-80940
Fuel System		
	Tab 3	
Section Index - Fuel System		6-81230
For Fuel System Repair, See the Engine Service Manual		6-80940
Electrical		
	Tab 4	
Section Index - Electrical		6-81240
Removal and Installation of Starter and Alternator	4001	6-81250
Electrical Specifications and Troubleshooting	4002	6-81260
Batteries	4003	6-81270
Instrument Cluster and Digital Display	4005	6-81280

Reprinted

W110 and W130 Wheel Loader Service Manual 6-81160

Table of Contents

Description	Section No.	Form No.
Steering		
	Tab 5	
Section Index - Steering		6-81290
Removal and Installation of Steering Components	5001	6-81300
Steering Specifications, Pressure Checks, and Troubleshooting	5002	6-81310
Steering Control Valve	5003	6-81320
Auxiliary Steering Priority Valve	5004	6-81330
Steering Cylinders	5005	6-81340
Center Pivot	5006	6-81350
Auxiliary Steering Motor and Pump	5007	6-81360
Power Train		
	Tab 6	
Section Index - Power Train		6-81370
Removal and Installation of Power Train Components	6001	6-81380
Transmission Specifications, Pressure Checks, and Troubleshooting	6002	6-81390
Transmission	6003	6-81400
Front Axle	6004	6-81410
Rear Axle	6004	6-81420
Drive Shafts, Center Bearing, and Universal Joints	6005	6-81430
Wheels and Tires	6006	6-81440
Transmission Control Valve	6007	6-81450
Brakes		
	Tab 7	
Section Index - Brakes		6-81460
Removal and Installation of Brake Components	7001	6-81470
Hydraulic Brake Troubleshooting	7002	6-81480
Brake Accumulators	7004	6-81490
Parking Brake	7008	6-81500
Hydraulics		
	Tab 8	
Section Index - Hydraulics		6-81510
Removal and Installation of Hydraulic Components	8001	6-81520
Hydraulic Specifications, Troubleshooting, and Pressure Checks	8002	6-81530
Cleaning the Hydraulic System	8003	6-81540
Loader Control Valve	8005	6-81550
Cylinders	8006	6-81560
Coupler Solenoid Locking Valve	8007	6-81570
Pilot Pressure Accumulator and Ride Control Accumulator	8013	6-81580
Ride Control Valve	8014	6-81590

W110 and W130 Wheel Loader Service Manual 6-81160

Table of Contents

Description	Section No.	Form No.
Mounted Equipment	Tab 9	
Section Index - Mounted Equipment		6-81600
Pedal and Levers	9001	6-81610
Air Conditioning Troubleshooting and System Checks For Systems with HFC-134a Refrigerant	9002	6-81620
Air Conditioner System Service	9003	6-81630
Removal and Installation of Air Conditioning and Heater Components	9004	6-81640
Loader	9006	6-81650
ROPS Cab and ROPS Canopy	9007	6-81660
Cab Glass Installation	9010	6-81670
Electrical Schematic Foldouts and Hydraulic Schematic Foldouts	In Rear Pocket	6-81680

NOTE: CNH America LLC reserves the right to make improvements in design or changes in specifications at any time without incurring any obligation to install them on units previously sold.

SECTION INDEX

GENERAL

Section Title	Section Number
Standard Torque Specifications	1001
Fluids and Lubricants	1002
Metric Conversion Chart	1003

Section 1001

GENERAL TORQUE SPECIFICATIONS

TABLE OF CONTENTS

TORQUE SPECIFICATIONS - DECIMAL HARDWARE	3
TORQUE SPECIFICATIONS - METRIC HARDWARE	4
TORQUE SPECIFICATIONS - STEEL HYDRAULIC FITTINGS	5
TORQUE SPECIFICATIONS - STEEL HYDRAULIC FITTINGS	6

TORQUE SPECIFICATIONS - DECIMAL HARDWARE

Use the torques in this chart when special torques are not given. These torques apply to fasteners with both UNC and UNF threads as received from suppliers dry, or when lubricated with engine oil. Not applicable if special graphities, Molydisulfide greases, or other extreme pressure lubricants are used.

Grade 5 Bolts, Nuts, and Studs		
		
Size	Pound-Inches	Newton metres
1/4 inch	108 to 132	12 to 15
5/16 inch	204 to 252	23 to 28
3/8 inch	420 to 504	48 to 57
Size	Pound-Feet	Newton metres
7/16 inch	54 to 64	73 to 87
1/2 inch	80 to 96	109 to 130
9/16 inch	110 to 132	149 to 179
5/8 inch	150 to 180	203 to 244
3/4 inch	270 to 324	366 to 439
7/8 inch	400 to 480	542 to 651
1.0 inch	580 to 696	787 to 944
1-1/8 inch	800 to 880	1085 to 1193
1-1/4 inch	1120 to 1240	1519 to 1681
1-3/8 inch	1460 to 1680	1980 to 2278
1-1/2 inch	1940 to 2200	2631 to 2983

Grade 8 Bolts, Nuts, and Studs		
		
Size	Pound-Inches	Newton metres
1/4 inch	144 to 180	16 to 20
5/16 inch	288 to 348	33 to 39
3/8 inch	540 to 648	61 to 73
Size	Pound-Feet	Newton metres
7/16 inch	70 to 84	95 to 114
1/2 inch	110 to 132	149 to 179
9/16 inch	160 to 192	217 to 260
5/8 inch	220 to 264	298 to 358
3/4 inch	380 to 456	515 to 618
7/8 inch	600 to 720	814 to 976
1.0 inch	900 to 1080	1220 to 1465
1-1/8 inch	1280 to 1440	1736 to 1953
1-1/4 inch	1820 to 2000	2468 to 2712
1-3/8 inch	2380 to 2720	3227 to 3688
1-1/2 inch	3160 to 3560	4285 to 4827
NOTE: Use thick nuts with Grade 8 bolts.		

TORQUE SPECIFICATIONS - METRIC HARDWARE

Use the following torques when specifications are not given.

These values apply to fasteners with coarse threads as received from supplier, plated or unplated, or when lubricated with engine oil. These values do not apply if graphite or Molydisulfide grease or oil is used.

Grade 8.8 Bolts, Nuts, and Studs		
		
Size	Pound-Inches	Newton metres
M4	24 to 36	3 to 4
M5	60 to 72	7 to 8
M6	96 to 108	11 to 12
M8	228 to 276	26 to 31
M10	456 to 540	52 to 61
Size	Pound-Feet	Newton metres
M12	66 to 79	90 to 107
M14	106 to 127	144 to 172
M16	160 to 200	217 to 271
M20	320 to 380	434 to 515
M24	500 to 600	675 to 815
M30	920 to 1100	1250 to 1500
M36	1600 to 1950	2175 to 2600

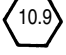
Grade 10.9 Bolts, Nuts, and Studs		
		
Size	Pound-Inches	Newton metres
M4	36 to 48	4 to 5
M5	84 to 96	9 to 11
M6	132 to 156	15 to 18
M8	324 to 384	37 to 43
Size	Pound-Feet	Newton metres
M10	54 to 64	73 to 87
M12	93 to 112	125 to 150
M14	149 to 179	200 to 245
M16	230 to 280	310 to 380
M20	450 to 540	610 to 730
M24	780 to 940	1050 to 1275
M30	1470 to 1770	2000 to 2400
M36	2580 to 3090	3500 to 4200

Grade 12.9 Bolts, Nuts, and Studs

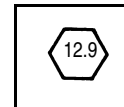

Usually the torque values specified for grade 10.9 fasteners can be used satisfactorily on grade 12.9 fasteners.

TORQUE SPECIFICATIONS - STEEL HYDRAULIC FITTINGS

37 Degree Flare Fitting			
Tube OD Hose ID	Thread Size	Pound- Inches	Newton metres
1/4 inch 6.4 mm	7/16-20	72 to 144	8 to 16
5/16 inch 7.9 mm	1/2-20	96 to 192	11 to 22
3/8 inch 9.5 mm	9/16-18	120 to 300	14 to 34
1/2 inch 12.7 mm	3/4-16	180 to 504	20 to 57
5/8 inch 15.9 mm	7/8-14	300 to 696	34 to 79
Tube OD Hose ID	Thread Size	Pound- Feet	Newton metres
3/4 inch 19.0 mm	1-1/16-12	40 to 80	54 to 108
7/8 inch 22.2 mm	1-3/16-12	60 to 100	81 to 135
1.0 inch 25.4 mm	1-5/16-12	75 to 117	102 to 158
1-1/4 inch 31.8 mm	1-5/8-12	125 to 165	169 to 223
1-1/2 inch 38.1 mm	1-7/8-12	210 to 250	285 to 338

Straight Threads with O-ring			
Tube OD Hose ID	Thread Size	Pound- Inches	Newton metres
1/4 inch 6.4 mm	7/16-20	144 to 228	16 to 26
5/16 inch 7.9 mm	1/2-20	192 to 300	22 to 34
3/8 inch 9.5 mm	9/16-18	300 to 480	34 to 54
1/2 inch 12.7 mm	3/4-16	540 to 804	57 to 91
Tube OD Hose ID	Thread Size	Pound- Feet	Newton metres
5/8 inch 15.9 mm	7/8-14	58 to 92	79 to 124
3/4 inch 19.0 mm	1-1/16-12	80 to 128	108 to 174
7/8 inch 22.2 mm	1-3/16-12	100 to 160	136 to 216
1.0 inch 25.4 mm	1-5/16-12	117 to 187	159 to 253
1-1/4 inch 31.8 mm	1-5/8-12	165 to 264	224 to 357
1-1/2 inch 38.1 mm	1-7/8-12	250 to 400	339 to 542

Split Flange Mounting Bolts		
Size	Pound- Inches	Newton metres
5/16-18	180 to 240	20 to 27
3/8-16	240 to 300	27 to 34
7/16-14	420 to 540	47 to 61
Size	Pound- Feet	Newton metres
1/2-13	55 to 65	74 to 88
5/8-11	140 to 150	190 to 203

TORQUE SPECIFICATIONS - STEEL HYDRAULIC FITTINGS

O-ring Face Seal End					O-ring Boss End Fitting or Lock Nut		
Nom. SAE Dash Size	Tube OD	Thread Size	Pound- Inches	Newton metres	Thread Size	Pound- Inches	Newton metres
-4	1/4 inch 6.4 mm	9/16-18	120 to 144	14 to 16	7/16-20	204 to 240	23 to 27
-6	3/8 inch 9.5 mm	11/16-16	216 to 240	24 to 27	9/16-18	300 to 360	34 to 41
-8	1/2 inch 12.7 mm	13/16-16	384 to 480	43 to 54	3/4-16	540 to 600	61 to 68
					Thread Size	Pound- Feet	Newton metres
-10	5/8 inch 15.9 mm	1-14	552 to 672	62 to 76	7/8-14	60 to 65	81 to 88
Nom. SAE Dash Size	Tube OD	Thread Size	Pound- Feet	Newton metres	1-1/16-12	85 to 90	115 to 122
					1-3/16-12	95 to 100	129 to 136
-12	3/4 inch 19.0 mm	1-3/16-12	65 to 80	90 to 110	1-5/16-12	115 to 125	156 to 169
-14	7/8 inch 22.2 mm	1-3/16-12	65 to 80	90 to 110	1-5/8-12	150 to 160	203 to 217
-16	1.0 inch 25.4 mm	1-7/16-12	92 to 105	125 to 140	1-7/8-12	190 to 200	258 to 271
-20	1-1/4 inch 31.8 mm	1-11/16-12	125 to 140	170 to 190			
-24	1-1/2 inch 38.1 mm	2-12	150 to 180	200 to 254			

Section 1002

1002

FLUIDS AND LUBRICANTS W110 AND W130

TABLE OF CONTENTS

CAPACITIES AND LUBRICANTS	3
CONVERSION FORMULAS	3
HYDRAULIC OIL TEMPERATURE CHART	4
TRANSMISSION OIL TEMPERATURE CHART	4
ENGINE OIL TEMPERATURE CHART	4
ENGINE OIL RECOMMENDATIONS	5
DIESEL FUEL SYSTEM	5
Fuel Storage	5
Specifications for Acceptable No. 2 Diesel Fuel	5
MAINTENANCE SCHEDULE	6
Model W110 and W130	6
MAINTENANCE POINTS	7
Model W110 and W130	7

CAPACITIES AND LUBRICANTS

Engine Oil

W110 Capacity with Filter Change	11.3 litres (12 U.S. quarts)
W130 Capacity with Filter Change	16.1 litres (17 U.S. quarts)
Type of oil	New Holland AMBRA Mastergold HSP engine oil

Engine Cooling System

W110 Capacity	21.8 litres (23 U.S. quarts)
W130 Capacity	24 litres (6.3 U.S. gallons)
Type of Coolant	Ethylene glycol and water mixed for lowest ambient temperature (at least 50/50 mix)

Fuel Tank W110 and W130

Capacity	189 litres (50 U.S. gallons)
Type of Fuel.....	See Diesel fuel specifications

Hydraulic System W110 and W130

Hydraulic Reservoir Refill Capacity with Filter Change	68.5 litres (18 U.S. gallons)
Total System Capacity	113.6 litres (30 U.S. gallons)
Type of Oil	New Holland AMBRA Master-Tran

Transmission W110 and W130

Total System Capacity	26 litres (6.87 U.S. gallons)
Refill Capacity with Filter Change	18.9 litres (20.0 U.S. quarts)
Type of Oil	See Transmission Oil Temperature Chart

Axles W110 and W130

Front Axle Capacity	22 litres (23.2 U.S. quarts)
Rear Axle Capacity	23.2 litres (24.5 U.S. quarts)
Type of Lubricant.....	New Holland Transaxle Fluid, 80W-140

See Note

Additive Capacity.....	2.1 litres (2.25 U.S. quarts)
Type of Lubricant.....	New Holland AMBRA Limited Slip Additive

Brake System W110 and W130

Type of Fluid (Same as Hydraulic System)	New Holland AMBRA Master-Tran
--	-------------------------------

NOTE: *DO NOT use an alternate oil in the axles. The brake components in the axles could be damaged as a result of using an alternate oil. Limited slip additive is not required with New Holland Transaxle Fluid.*

CONVERSION FORMULAS

Imperial quart = litres x 0.879877

Imperial gallons = litres x 0.219969

HYDRAULIC OIL TEMPERATURE CHART

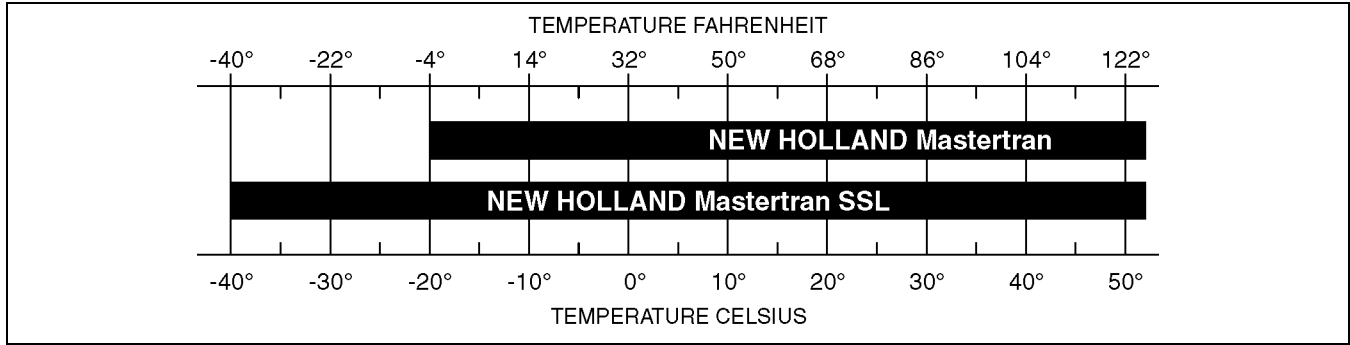

BC06B394

TRANSMISSION OIL TEMPERATURE CHART

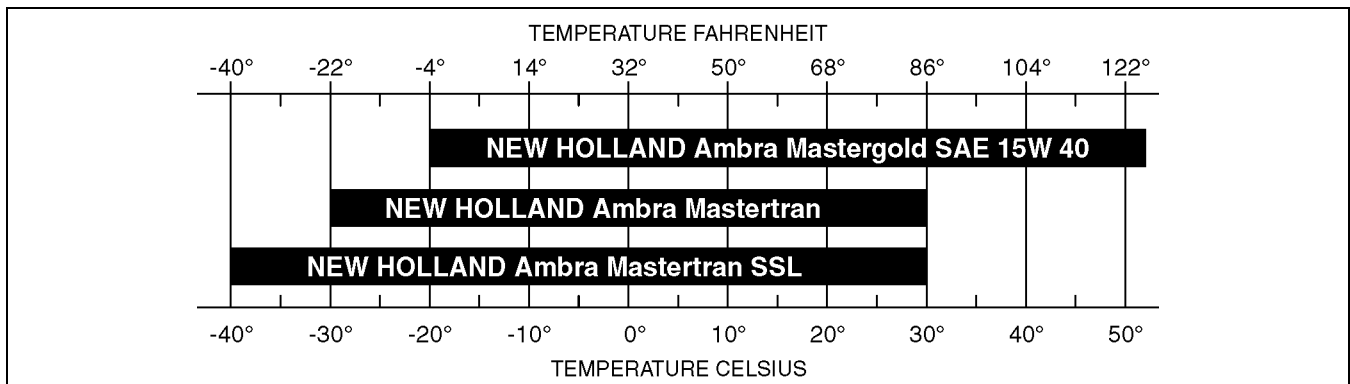

BC06B395

ENGINE OIL TEMPERATURE CHART

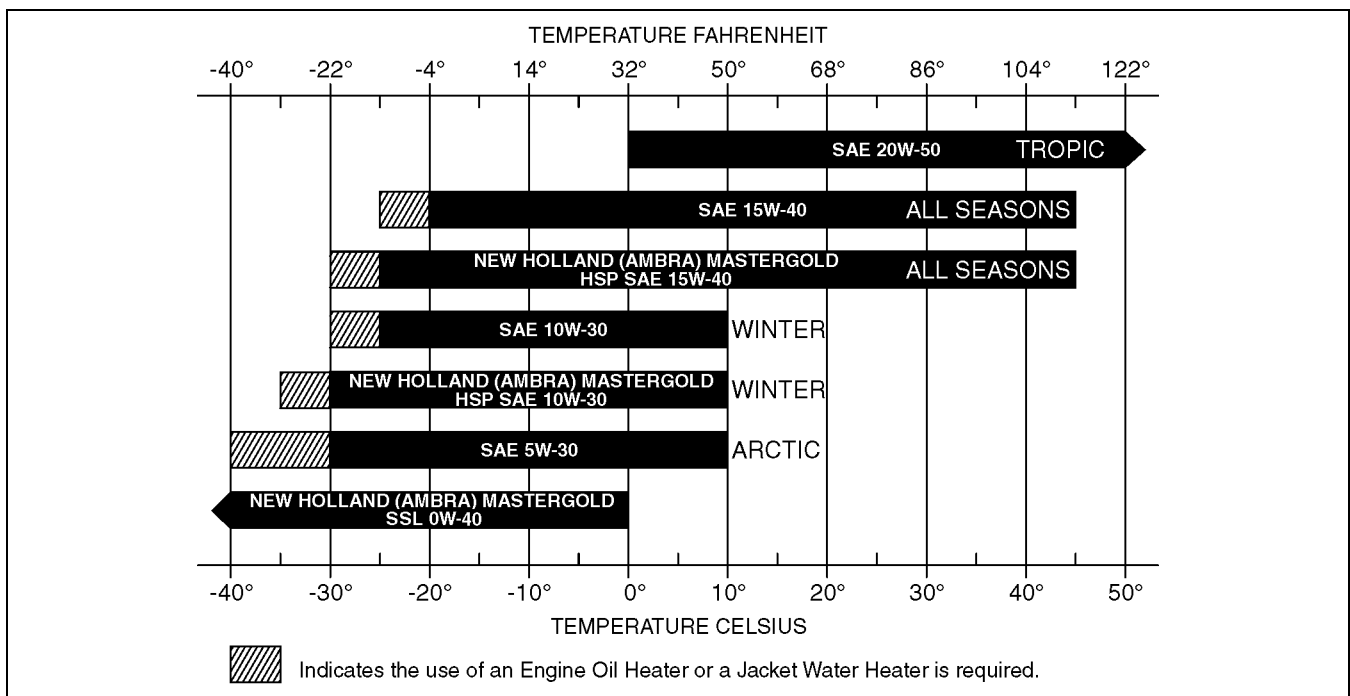

BC06B150

ENGINE OIL RECOMMENDATIONS

New Holland AMBRA Engine oil is recommended for use in your New Holland engine. New Holland AMBRA Engine Oil will lubricate your engine correctly under all operating conditions.

If New Holland AMBRA Multi-Viscosity or Single Grade Engine Oil is not available, use only oil meeting API engine oil service category CH.



NOTE: Do not put performance additives or other oil additive products in the engine crankcase. The oil change intervals given in this manual are according to tests with New Holland lubricants.

DIESEL FUEL SYSTEM

Use No. 2 diesel fuel in the engine of this machine. The use of other fuels can cause the loss of engine power and high fuel consumption.

In very cold temperatures, a mixture of No. 1 and No. 2 diesel fuels is temporarily permitted. See the following Note.

NOTE: See your fuel dealer for winter fuel requirements in your area. If the temperature of the fuel lowers below the cloud point (wax appearance point), wax crystals in the fuel will restrict the fuel filter and cause the engine to lose power or not start.

The diesel fuel used in this machine must meet the specifications as shown below in, "Specifications for Acceptable No. 2 Diesel Fuel", or "Specification D975-81" of the American Society for Testing and Materials.

Specifications for Acceptable No. 2 Diesel Fuel

API gravity, minimum	34
Flash point, minimum	60°C (140°F)
Cloud point (wax appearance point), maximum	-20°C (-5°F) See Note above
Pour point, maximum	-26°C (-15°F) See Note above
Distillation temperature, 90% point	282 to 338°C (540 to 640°F)
Viscosity, at 38°C (100°F) Centistokes	2.0 to 4.3
Cetane number, minimum	43 (45 to 55 for winter or high altitudes)
Water and sediment, by volume, maximum	0.05%

Fuel Storage

If you keep fuel in storage for a period of time, you can get foreign material or water in the fuel storage tank. Many engine problems are caused by water in the fuel.

Keep the fuel storage tank outside and keep the fuel as cool as possible. Remove water from the storage container at regular periods of time.

Fill the fuel tank at the end of the daily operating period to prevent condensation in the fuel tank.

MAINTENANCE SCHEDULE

Model W110 and W130

Instructions

AS REQUIRED

- 22 SERVICE THE AIR CLEANER IF THE AIR CLEANER WARNING LAMP ILLUMINATES SEE OPERATORS MANUAL
- 30 REPLACE THE TRANSMISSION FILTER
IF THE TRANSMISSION FILTER RESTRICTION WARNING LAMP ILLUMINATES.....USE NEW HOLLAND FILTER
- 19 CHECK THE RADIATOR COOLANT LEVEL IF THE WARNING LAMP ILLUMINATES SEE OPERATORS MANUAL
- 6 REPLACE THE HYDRAULIC FILTER IF THE HYDRAULIC FILTER WARNING LAMP ILLUMINATES.....USE NEW HOLLAND FILTER
CHECK THE AIR CONDITIONING DRIVE TENSION (IF EQUIPPED) NOT SHOWNADJUST AS REQUIRED

EVERY 10 HOURS OF OPERATION OR EACH DAY - WHICHEVER OCCURS FIRST

- 16 CHECK THE ENGINE OIL LEVEL..... SEE OPERATORS MANUAL

EVERY 50 HOURS OF OPERATION

- 1 CHECK THE COOLANT RESERVOIR FLUID LEVEL..... ETHYLENE GLYCOL AND WATER
- 29 CHECK THE TRANSMISSION OIL LEVEL (ENGINE RUNNING AND OIL WARM)..... SEE OPERATORS MANUAL
- 5 CHECK THE HYDRAULIC RESERVOIR FLUID LEVEL SEE OPERATORS MANUAL
- 38 LUBRICATE THE BUCKET AND BELLCRANK PIVOT POINTS (10 FITTINGS) TC NEW HOLLAND AMBRA GR 75 MD GREASE
- 39 LUBRICATE THE BELLCRANK AND BUCKET PIVOTS (6 FITTINGS) Z-BAR NEW HOLLAND AMBRA GR 75 MD GREASE

EVERY 100 HOURS OF OPERATION

- 7 LUBRICATE THE STEERING CYLINDER PIVOTS - ROD AND CLOSED END (4 FITTINGS) . NEW HOLLAND AMBRA GR 75 MD GREASE
- 40 LUBRICATE THE LOADER LIFT ARM AND CYLINDER PIVOTS (7 FITTINGS) Z-BAR NEW HOLLAND AMBRA GR 75 MD GREASE
- 26 LUBRICATE THE FRONT DRIVE SHAFT SUPPPORT BEARING (1 FITTING) NEW HOLLAND AMBRA GR 75 MD GREASE
- 8 LUBRICATE THE LOADER LIFT ARM AND CYLINDER PIVOTS (14 FITTINGS) TC NEW HOLLAND AMBRA GR 75 MD GREASE
- 31 CHANGE THE FRONT/REAR AXLE OIL SEE OPERATORS MANUAL
- 39 INITIAL TRANSMISSION CLUTCH CALIBRATION..... SEE OPERATORS MANUAL OR SEE SERVICE MANUAL SECTION 4005

EVERY 250 HOURS OF OPERATION

- 19 CHECK THE RADIATOR COOLANT LEVEL..... ETHYLENE GLYCOL AND WATER
- 2 CHANGE THE ENGINE OIL AND REPLACE THE ENGINE OIL FILTER SEE OPERATORS MANUAL
- 34 CHECK THE BATTERY FLUID LEVEL SEE OPERATORS MANUAL
- 36 CHECK THE TIRE CONDITION AND AIR PRESSURE..... SEE OPERATORS MANUAL
- 12 CLEAN THE CAB AIR FILTERS (IF EQUIPPED) SEE OPERATORS MANUAL

EVERY 500 HOURS OF OPERATION

- 3 REPLACE THE FUEL FILTER USE NEW HOLLAND FILTER
- 33 DRAIN WATER AND SEDIMENT FROM THE FUEL TANK SEE OPERATORS MANUAL
- 14 REPLACE THE IN-LINE FUEL FILTER USE NEW HOLLAND FILTER

EVERY 1000 HOURS OF OPERATION

- 21 CHECK THE ENGINE VALVE CLEARANCES SEE SERVICE MANUAL
- 6 REPLACE THE HYDRAULIC FILTER.....USE NEW HOLLAND FILTER
- 30 REPLACE THE TRANSMISSION OIL FILTERUSE NEW HOLLAND FILTER
- 28 CHANGE THE TRANSMISSION OIL..... SEE OPERATORS MANUAL
- 23 CLEAN THE TRANSMISSION BREATHER..... CLEAN WITH SOLVENT
- 24 LUBRICATE THE UPPER AND LOWER CHASSIS PIVOTS (2 FITTINGS) NEW HOLLAND AMBRA GR 75 MD GREASE
- 31 CHANGE THE FRONT/REAR AXLE OIL SEE OPERATORS MANUAL
- 39 TRANSMISSION CLUTCH CALIBRATION..... SEE OPERATORS MANUAL OR SEE SERVICE MANUAL SECTION 4005

EVERY 2000 HOURS OF OPERATION OR EACH YEAR - WHICHEVER OCCURS FIRST

- 4 CHANGE THE HYDRAULIC OIL SEE OPERATORS MANUAL
- 18 DRAIN, FLUSH AND REFILL THE ENGINE COOLING SYSTEM ETHYLENE GLYCOL AND WATER
- 22 REPLACE THE AIR CLEANER ELEMENTS USE NEW HOLLAND FILTERS

MAINTENANCE POINTS

Model W110 and W130

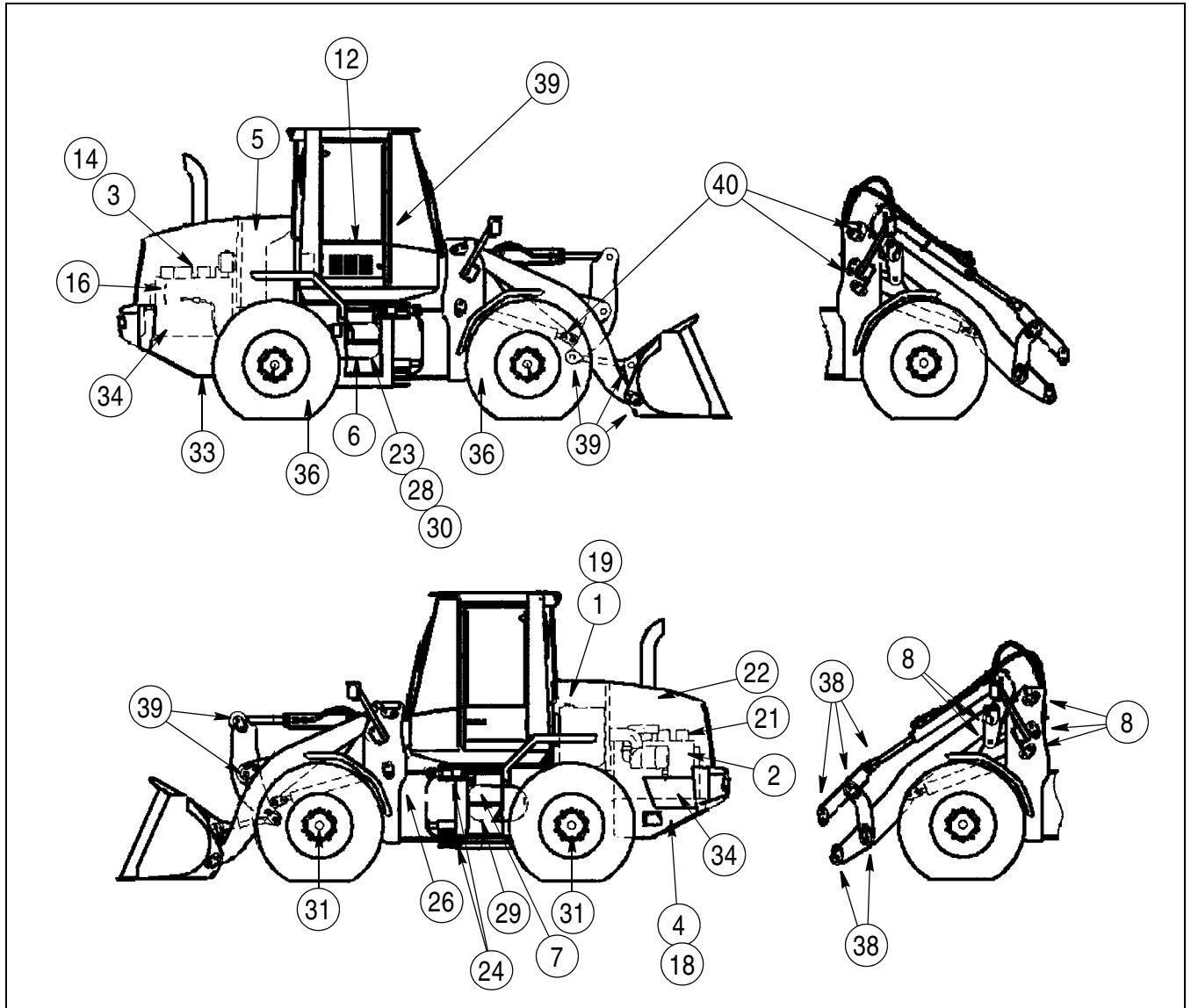

BS01B021

See your Operators manual for maintenance of safety related items and for detailed information of the service items on this chart. Operators and service manuals are available for this machine from your dealer.

**Thanks very much for your reading,
Want to get more information,
Please click here, Then get the complete
manual**

JustClickHere 

NOTE:

**If there is no response to click on the link above,
please download the PDF document first, and then
click on it.**

**Have any questions please write to me:
admin@servicemanualperfect.com**